



REV	DATE	DESCRIPTION
B	24-06-20	Modified impacts for attenuation tanks and related services.
C	04-08-20	Modified impacts for attenuation tanks and related services.
D	05-08-20	Amended client and address titleblock details, updated underground services reference.
E	06-01-21	Adjusted position of underground services tank east of building A.
F	07-04-21	New survey information from update report.
G	11-08-21	New landscaping inputs

LEGEND

ARBORICULTURAL IMPACT

- TREES TO BE RETAINED
- TREES TO BE REMOVED TO FACILITATE DEVELOPMENT
- CATEGORY C TREES TO BE REMOVED IN THE INTERESTS OF IMPROVING PUBLIC SPACE AREAS
- CATEGORY U TREES OF VERY LOW VALUE AND QUALITY TO BE REMOVED IN THE INTERESTS OF SOUND ARBORICULTURAL MANAGEMENT

— SITE BOUNDARY
 — UNDERGROUND SERVICES
 — BASEMENT

DRAWING TO BE INTERPRETED WITH REFERENCE TO THE ARBORICULTURAL ASSESSMENT AND IMPACT REPORT

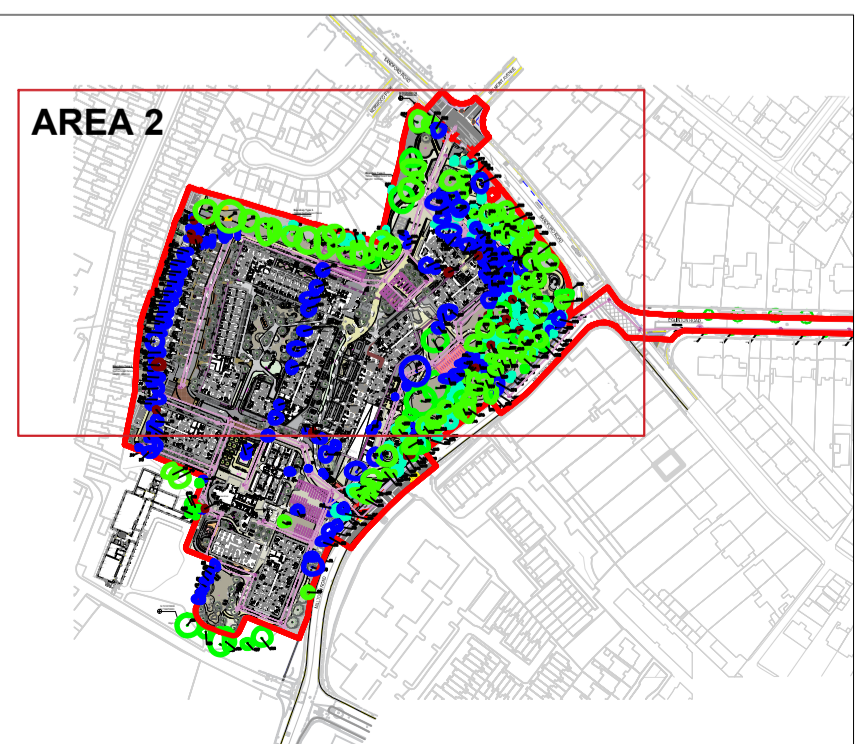

CMK
 Horticulture & Acoustics Ltd

Client: SANDFORD LIVING LIMITED	PROJECT: MILLTOWN PARK, SANDFORD ROAD, DUBLIN 8	JOB NO. TSAN001
DRAWING: Arboricultural Impact (2 of 2)	DATE: 11-08-21	SCALE: 1:400 @ A1
DRAWN BY: Neil McBride	NMB INITIALS	REVISION: 10

NOTES: This drawing is copyright of CMK Horticulture & Acoustics Ltd. © 2021. All rights reserved. No part of this drawing may be reproduced without the prior written consent of CMK Horticulture & Acoustics Ltd.

STATUS: PLANNING